

COOLING FAN CONVERSION KIT

Wiring Instructions

MX-5 (NB)

Part Number: RY1269



Fan Conversion to Mazda Loom

1. Using wire cutters, remove the white plug from the supplied fan.

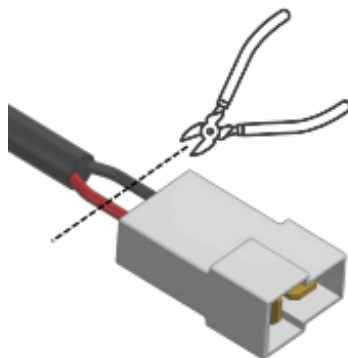

2. Slide the cables through the supplied rubber seals before removing $\frac{1}{4}$ " (6mm) of shroud to reveal the wire core. Crimp the male spade connectors, noting the rubber seal position, as shown.

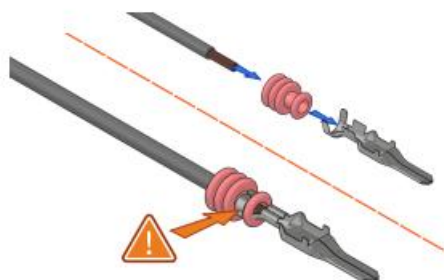

3. Noting the polarity, insert the crimped terminals into the supplied NB connector. Ensure the cables are fully located.

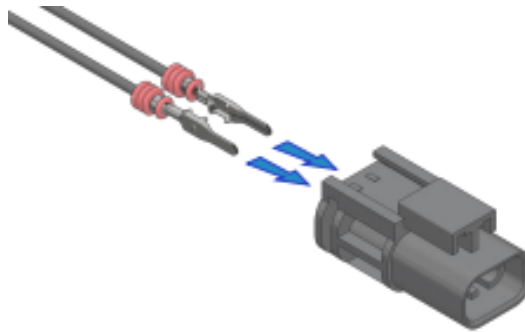

4. Install the red locking tab to secure the cables in place.

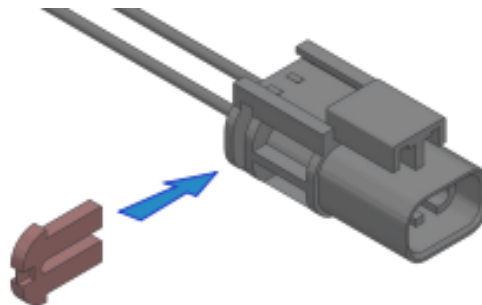

Loom Conversion to Revotec Fan

1. Using wire cutters, remove the OEM plug from the vehicle wiring loom.

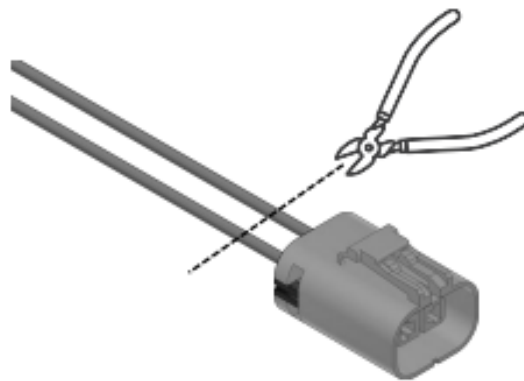

2. Remove ¼" (6mm) of cable shroud to reveal the wire core. Crimp the female spade connectors as shown.

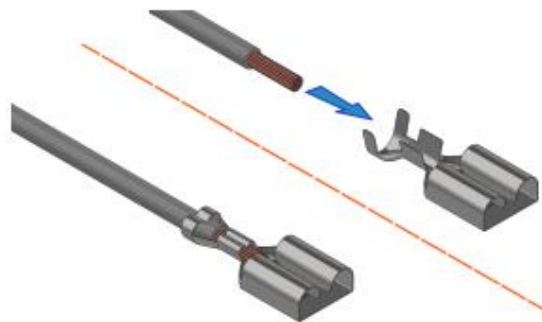

3. Noting the polarity, insert the crimped spade terminals into the supplied RTB-2 connector as shown. Ensure the cables are fully located - retaining catches will click into place.

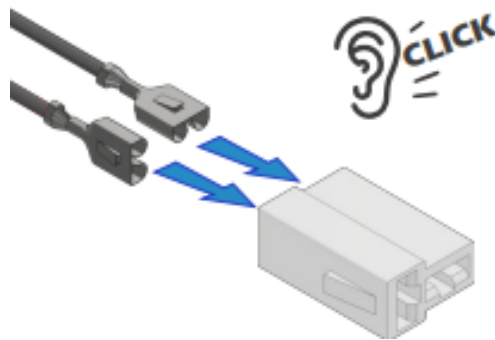

Important Notes

Installations are to be undertaken by a competent vehicle mechanic. If in doubt, consult a qualified professional. Always work in a safe environment and wear PPE where necessary. Disconnect the vehicle battery before beginning installation. Failure to comply with the above may result in your warranty being void

